

FURNITURE SPECIFICATIONS
MIDWESTERN STATE UNIVERSITY
Moffett Library Renovation - Phase 2A

Contact: Alyson Kritz
akritz@holzmanmossbottino.com
212.465.0808

HOLZMAN MOSS BOTTINO
ARCHITECTURE

90 Broad Street, Suite 1803
New York, New York 10004
T: 212.465.0808



4724 Old Jacksonboro Hwy.
Wichita Falls, TX 76302
T: 940.397.0273

MIDWESTERN STATE UNIVERSITY
MOFFETT LIBRARY RENOVATION

FURNITURE BID PACKAGE
PHASE 2A

FURNITURE SPECIFICATIONS

MIDWESTERN STATE UNIVERSITY

Moffett Library Renovation - Phase 2A

Contact: Alyson Kritz
akritz@holzmanmossbottino.com
212.465.0808

HOLZMAN MOSS BOTTINO ARCHITECTURE

90 Broad Street, Suite 1803
New York, New York 10004
T: 212.465.0808



4724 Old Jacksonboro Hwy.
Wichita Falls, TX 76302
T: 940.397.0273

Dear Furniture Distributors,

We invite your company to submit a furniture proposal for the Phase 2A portion of the Moffett Library Renovation. Please see the attached Request for Proposal provided by the MSU Purchasing & Contract Management Department for proposal requirements and due dates. Additional information, instructions, and requirements are listed below.

I. PROJECT DESCRIPTION:

The project is located at Midwestern State University. Three floors, totaling approximately 45,000 square feet of existing space is being re-purposed to improve and update the library. This phase of furniture, phase 2A, includes only small portions of the second floor. The following spaces are to be furnished: twenty-nine existing, small group study rooms, an existing computer lab, and four newly constructed group lounge study rooms.

Students using this portion of the library will use the space for extended periods of time, three to four hours would not be unusual. Furniture on this floor should encourage group study and maximize collaboration. All furniture must be comfortable and sturdy. Construction will precede the installation of furniture. Improvements to this area include new carpet, new and/or improved ceilings, installation of new power and data at the perimeter walls and interior columns, patching and painting.

The project architects are Holzman Moss Bottino Architecture and Harper Perkins Architects. The Construction Manager is Shane Darnell at M&F Litteken. Furniture space plans have been prepared by the architect and coordinated with the CM for new power and data distribution. The furniture distributor will need to insure that at all furniture requiring power and data have access to power and data.

The products specified in the attached documents are basis-of-design to determine quality and design intent. Alternate furniture products that meet a similar quality and design intent will be considered with the appropriate documentation. Furniture dealerships will work with Holzman Moss Bottino Architecture and the Owner on all fabric and finish selections.

Furniture for the project will be purchased through the MSU Purchasing & Contract Management Department and follow state guidelines for pricing. The selected distributor will be contracted directly to MSU and will provide final design and furniture selection, procurement, and installation of all items. All distributor documentation must be in BIM.

Requested Furniture for this project includes*:

- (91) Student Chairs
- (16) Lounge Chairs
- (16) Powered, 2-Person, Computer Lab Tables
- (1) 4-Person Meeting Table
- (22) 2-Person Meeting Tables
- (8) Personal Laptop Tables

*All quantities to be confirmed via furniture plans.

FURNITURE SPECIFICATIONS
MIDWESTERN STATE UNIVERSITY
Moffett Library Renovation - Phase 2A

Contact: Alyson Kritz
akritz@holzmanmossbottino.com
212.465.0808

HOLZMAN MOSS BOTTINO
ARCHITECTURE

90 Broad Street, Suite 1803
New York, New York 10004
T: 212.465.0808



4724 Old Jacksonboro Hwy.
Wichita Falls, TX 76302
T: 940.397.0273

II. SCOPE OF SERVICES:

The following scope of services shall be undertaken by each dealer:

1. Review existing Architectural Documents to become familiar with the existing space on the second floor of the Library.
2. Review the second floor construction plan, furniture plan, electrical and data plans as prepared by Holzman Moss Bottino Architecture and Harper Perkins Architects.
3. Review the specifications herein, as well as any and all additional documents or appendices sent through the MSU Purchasing & Contract Management Department.
4. Prepare furniture selection proposal, including any alternates, for owner review. Proposal shall conform with all requirements listed in the RFP and listed herein.
5. Coordinate with Holzman Moss Bottino Architecture and the Owner on all fabric and finish selections.
6. Prepare a furniture installation plan and schedule. To be fully coordinated with the CM and arrange coordinated deliveries of items. Contractor is responsible for all debris removal from campus.
7. Inspect furniture installation for conformance with bid documents and space plan.
8. Prepare a punch list for installation.
9. Oversee corrections to installation as requires to secure owner approval. Punch list damage to completed spaces finishes by furniture must be recorded and completed by installer.

FURNITURE SPECIFICATIONS

MIDWESTERN STATE UNIVERSITY

Moffett Library Renovation - Phase 2A

Contact: Alyson Kritz
akritz@holzmanmossbottino.com
212.465.0808

HOLZMAN MOSS BOTTINO
ARCHITECTURE

90 Broad Street, Suite 1803
New York, New York 10004
T: 212.465.0808



4724 Old Jacksonboro Hwy.
Wichita Falls, TX 76302
T: 940.397.0273

III. ADDITIONAL PROPOSAL REQUIREMENTS:

In addition to all requirements and instructions listed in the RFP, all dealers must comply with the following:

1. Furniture dealers shall provide a tabulation sheet showing each item selected, quantity, list price, net price, and installed value. Fees indicating the total project cost should be divided into final documentation and owner approval, procurement, installation, and close out. All project related fees must be indicated in this summary.
2. Cut sheets to be provided for each item, including alternates.
3. When submitting an alternative: identify a product that matches construction, warranty, function, and general looks of the specified product. Power and data quantities must be met or exceeded without exception.
4. Furniture dealers shall submit warranties and sustainability documentation for each items specified and/or all substitutions. Substitutions maybe rejected if they do not meet or exceed those specified herein.
5. Dealer shall submit two sets of memo samples (preferably 6x6" or larger, no smaller than 2x4") for all final fabric and finish selections. Submit one set to Owner and one set to Holzman Moss Bottino Architecture.
6. Dealer shall submit a revised space plan in BIM showing proposed furniture selections. Key items to a final space plan indicating data and power hook up when applicable.
7. Furniture dealers to provide a written statement of follow-up service and punch list procedures.

Moffett Library Renovation - Phase 2A

Contact: Alyson Kritz
akritz@holzmanmossbottino.com
212.465.0808



90 Broad Street, Suite 1803
New York, New York 10004
T: 212.465.0808

4724 Old Jacksonboro Hwy.
Wichita Falls, TX 76302
T: 940.397.0273

FIRST FLOOR FURNITURE PLAN

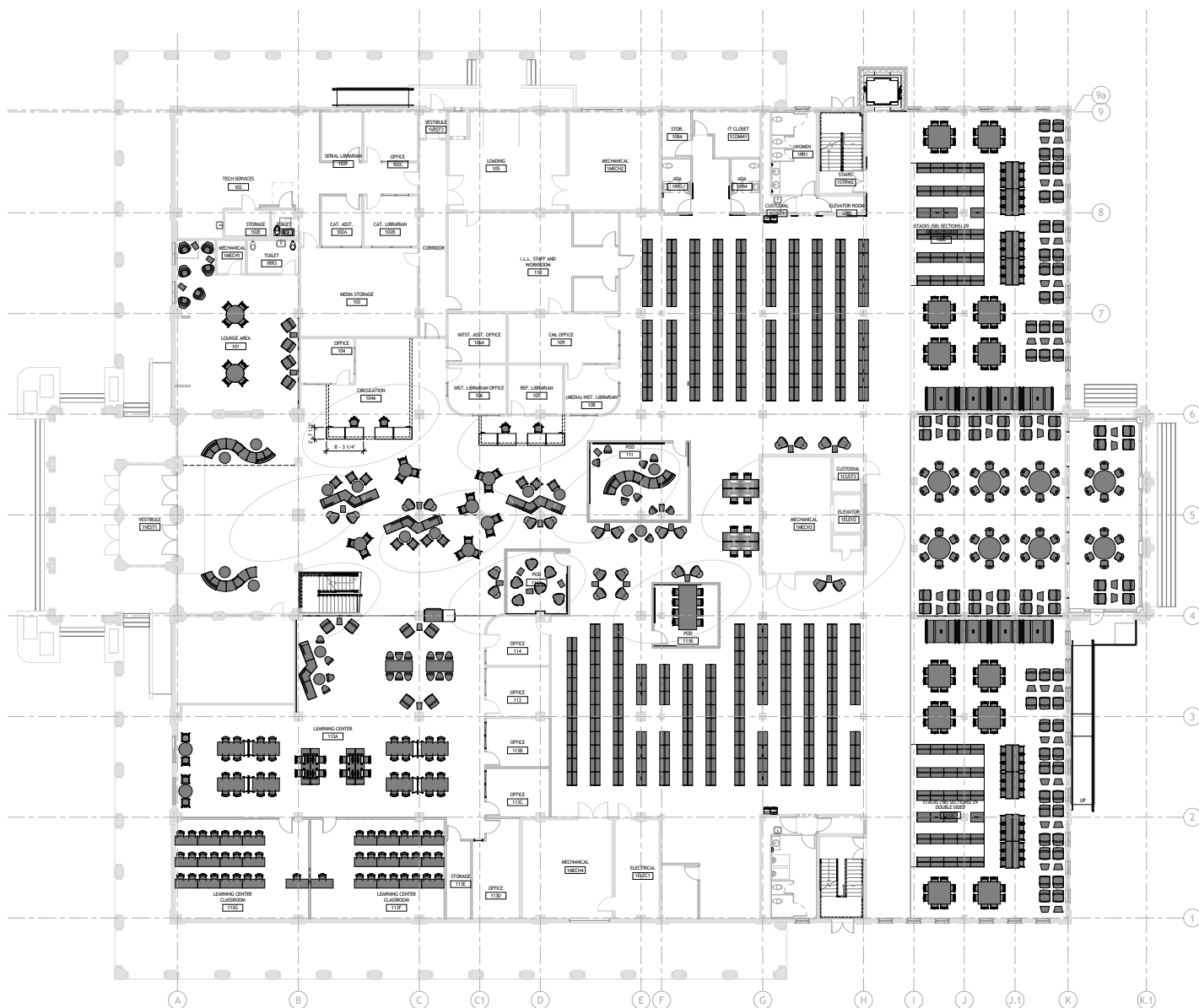

NOT IN SCOPE - NEXT PHASE OF FURNITURE TO BE BID FALL 2019

FURNITURE SPECIFICATIONS

MIDWESTERN STATE UNIVERSITY

Moffett Library Renovation - Phase 2A

Contact: Alyson Kritz
akritz@holzmanmossbottino.com
212.465.0808

HOLZMAN MOSS BOTTINO
ARCHITECTURE



90 Broad Street, Suite 1803
New York, New York 10004
T: 212.465.0808

4724 Old Jacksonboro Hwy.
Wichita Falls, TX 76302
T: 940.397.0273

SECOND FLOOR FURNITURE PLAN

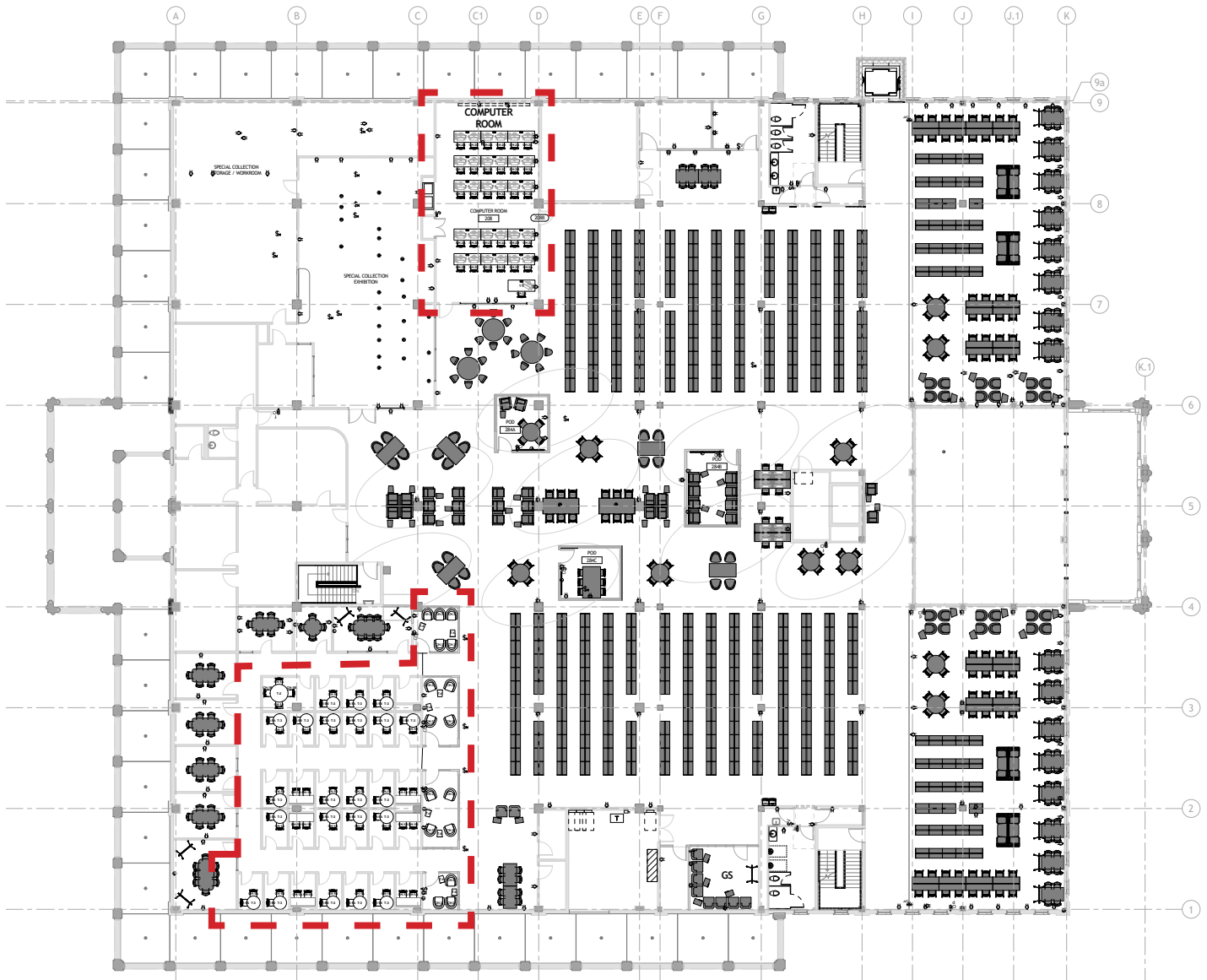

BASE BID



NOT IN SCOPE - NEXT PHASE OF FURNITURE TO BE BID FALL 2019

FURNITURE SPECIFICATIONS

MIDWESTERN STATE UNIVERSITY

Moffett Library Renovation - Phase 2A

Contact: Alyson Kritz
akritz@holzmanmossbottino.com
212.465.0808

HOLZMAN MOSS BOTTINO
ARCHITECTURE



90 Broad Street, Suite 1803
New York, New York 10004
T: 212.465.0808

4724 Old Jacksonboro Hwy.
Wichita Falls, TX 76302
T: 940.397.0273

THIRD FLOOR FURNITURE PLAN (NOT IN SCOPE)

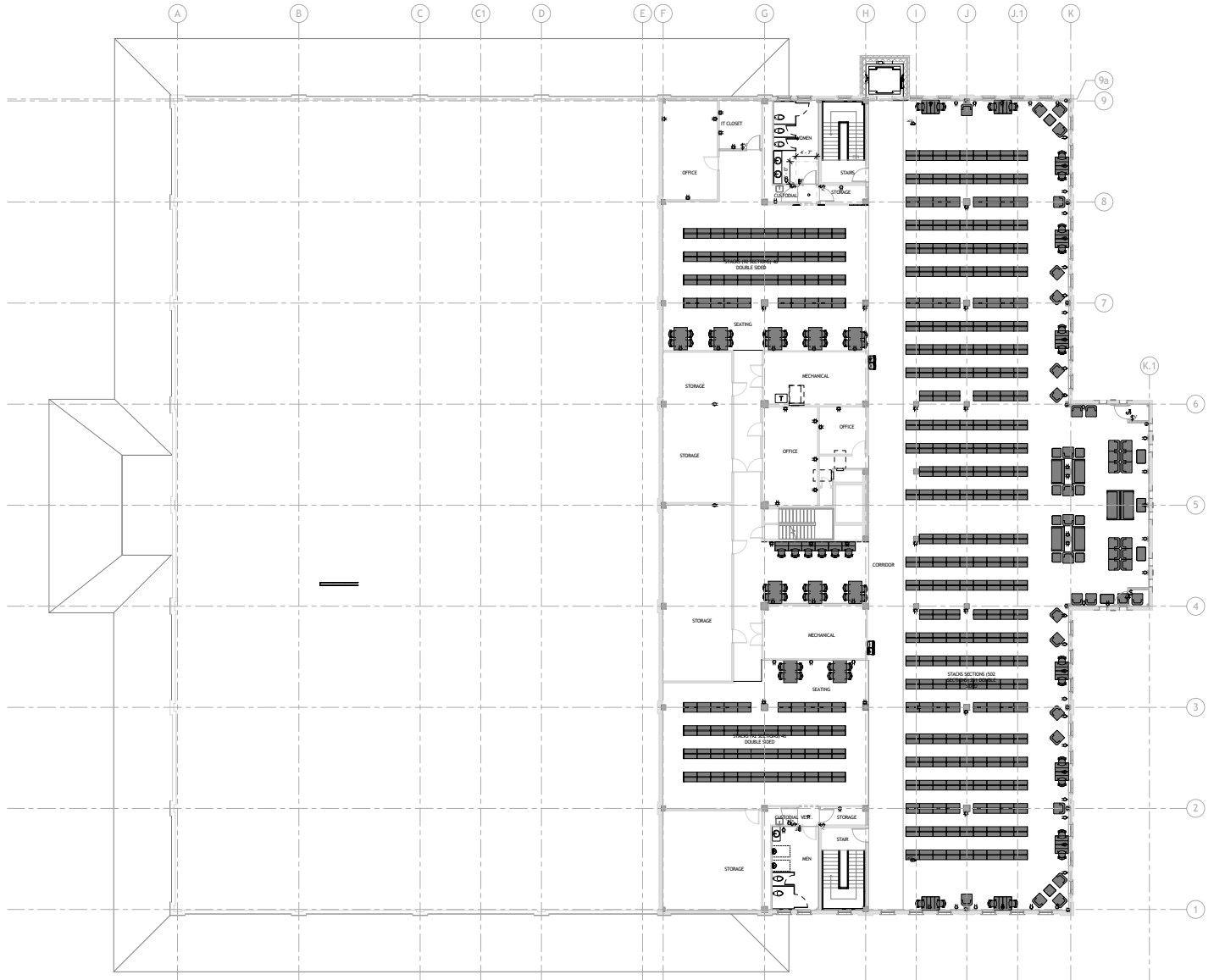

NOT IN SCOPE - NEXT PHASE OF FURNITURE TO BE BID FALL 2019

FURNITURE SPECIFICATIONS
MIDWESTERN STATE UNIVERSITY
Moffett Library Renovation - Phase 2A

Contact: Alyson Kritz
akritz@holzmanmossbottino.com
212.465.0808

HOLZMAN MOSS BOTTINO
ARCHITECTURE

90 Broad Street, Suite 1803
New York, New York 10004
T: 212.465.0808



4724 Old Jacksonboro Hwy.
Wichita Falls, TX 76302
T: 940.397.0273

BASE BID

FURNITURE SPECIFICATIONS

MIDWESTERN STATE UNIVERSITY

Moffett Library Renovation - Phase 2A

Contact: Alyson Kritz
akritz@holzmanmossbottino.com
212.465.0808

HOLZMAN MOSS BOTTINO
ARCHITECTURE



90 Broad Street, Suite 1803
New York, New York 10004
T: 212.465.0808

4724 Old Jacksonboro Hwy.
Wichita Falls, TX 76302
T: 940.397.0273

CH-1A



A

B

C

D

E

MANUFACTURER

Sit On It

REPRESENTATIVE

Carol Weiss
917.280.5193
Cweiss@exemplis.com

ITEM NAME

Rio

PRODUCT NUMBER

1051 FT1 A0 PS SC19 GL1 FC2 AC

DIMENSIONS

W21.2 x D21.6 x H33.4 x SH17.9

WARRANTY

Lifetime

Photo for Reference Only

SUSTAINABILITY

Qualifies for LEED credits, see manufacturer's specs for details; UL Greenguard Gold

LOCATION

Refer to furniture plans

ADDITIONAL COMMENTS

No Arms, Four Legs; Standard Multi-Surface Glides

QUANTITY

30

Dealer to verify quantity via furniture plans



A	FINISH TYPE	Poly Shell	B	FINISH TYPE	Metal Frame Finish
	GRADE			GRADE	
	MANUFACTURER	SitOnIt		MANUFACTURER	SitOnIt
	NAME & NUMBER			NAME & NUMBER	
	COLOR	Red		COLOR	Silver
	COMMENTS			COMMENTS	
C	FINISH TYPE		D	FINISH TYPE	
	GRADE			GRADE	
	MANUFACTURER			MANUFACTURER	
	NAME & NUMBER			NAME & NUMBER	
	COLOR			COLOR	
	COMMENTS			COMMENTS	

FURNITURE SPECIFICATIONS

MIDWESTERN STATE UNIVERSITY

Moffett Library Renovation - Phase 2A

Contact: Alyson Kritz
akritz@holzmanmossbottino.com
212.465.0808

HOLZMAN MOSS BOTTINO
ARCHITECTURE



90 Broad Street, Suite 1803
New York, New York 10004
T: 212.465.0808

4724 Old Jacksonboro Hwy.
Wichita Falls, TX 76302
T: 940.397.0273

CH-1B



A

B

C

D

E

MANUFACTURER

Sit On It

REPRESENTATIVE

Carol Weiss
917.280.5193
Cweiss@exemplis.com

ITEM NAME

Rio

PRODUCT NUMBER

DIMENSIONS

W21.2 x D21.6 x H33.4 x SH17.9

WARRANTY

Lifetime

Photo for Reference Only

SUSTAINABILITY

Qualifies for LEED credits, see manufacturer's specs for details; UL Greenguard Gold

LOCATION

Refer to furniture plans

ADDITIONAL COMMENTS

No Arms, Four Legs; Standard Multi-Surface Glides

QUANTITY

30

Dealer to verify quantity via furniture plans



A	FINISH TYPE	Poly	B	FINISH TYPE	
	GRADE			GRADE	
	MANUFACTURER	SitOnIt		MANUFACTURER	
	NAME & NUMBER			NAME & NUMBER	
	COLOR	Tangerine		COLOR	
	COMMENTS			COMMENTS	
C	FINISH TYPE		D	FINISH TYPE	
	GRADE			GRADE	
	MANUFACTURER			MANUFACTURER	
	NAME & NUMBER			NAME & NUMBER	
	COLOR			COLOR	
	COMMENTS			COMMENTS	

FURNITURE SPECIFICATIONS

MIDWESTERN STATE UNIVERSITY

Moffett Library Renovation - Phase 2A

Contact: Alyson Kritz
akritz@holzmanmossbottino.com
212.465.0808

HOLZMAN MOSS BOTTINO
ARCHITECTURE



90 Broad Street, Suite 1803
New York, New York 10004
T: 212.465.0808

4724 Old Jacksonboro Hwy.
Wichita Falls, TX 76302
T: 940.397.0273

CH-2A



A

B

C

D

E

MANUFACTURER

Sit On It

REPRESENTATIVE

Carol Weiss
917.280.5193
Cweiss@exemplis.com

ITEM NAME

Rio

PRODUCT NUMBER

DIMENSIONS

W21.2 x D21.6 x H33.4 x SH17.9

WARRANTY

Lifetime

Photo for Reference Only

SUSTAINABILITY

Qualifies for LEED credits, see manufacturer's specs for details; UL Greenguard Gold

LOCATION

Refer to furniture plans

ADDITIONAL COMMENTS

No Arms; Carpet Casters

QUANTITY

11

Dealer to verify quantity via furniture plans

A	FINISH TYPE	Poly	B	FINISH TYPE	
	GRADE			GRADE	
	MANUFACTURER	SitOnIt		MANUFACTURER	
	NAME & NUMBER			NAME & NUMBER	
	COLOR	Lemon		COLOR	
	COMMENTS			COMMENTS	

C	FINISH TYPE		D	FINISH TYPE	
	GRADE			GRADE	
	MANUFACTURER			MANUFACTURER	
	NAME & NUMBER			NAME & NUMBER	
	COLOR			COLOR	
	COMMENTS			COMMENTS	

FURNITURE SPECIFICATIONS

MIDWESTERN STATE UNIVERSITY

Moffett Library Renovation - Phase 2A

Contact: Alyson Kritz
akritz@holzmanmossbottino.com
212.465.0808

HOLZMAN MOSS BOTTINO
ARCHITECTURE



90 Broad Street, Suite 1803
New York, New York 10004
T: 212.465.0808

4724 Old Jacksonboro Hwy.
Wichita Falls, TX 76302
T: 940.397.0273

CH-2B



A

B

C

D

E

MANUFACTURER

Sit On It

REPRESENTATIVE

Carol Weiss
917.280.5193
Cweiss@exemplis.com

ITEM NAME

Rio

PRODUCT NUMBER

DIMENSIONS

W21.2 x D21.6 x H33.4 x SH17.9

WARRANTY

Lifetime

Photo for Reference Only

SUSTAINABILITY

Qualifies for LEED credits, see manufacturer's specs for details; UL Greenguard Gold

LOCATION

Refer to furniture plans

ADDITIONAL COMMENTS

No Arms; Carpet Casters

QUANTITY

10

Dealer to verify quantity via furniture plans

A	FINISH TYPE	Poly	B	FINISH TYPE	
	GRADE			GRADE	
	MANUFACTURER	SitOnIt		MANUFACTURER	
	NAME & NUMBER			NAME & NUMBER	
	COLOR	Pacific		COLOR	
	COMMENTS			COMMENTS	

C	FINISH TYPE		D	FINISH TYPE	
	GRADE			GRADE	
	MANUFACTURER			MANUFACTURER	
	NAME & NUMBER			NAME & NUMBER	
	COLOR			COLOR	
	COMMENTS			COMMENTS	

FURNITURE SPECIFICATIONS

MIDWESTERN STATE UNIVERSITY

Moffett Library Renovation - Phase 2A

Contact: Alyson Kritz
akritz@holzmanmossbottino.com
212.465.0808

HOLZMAN MOSS BOTTINO
ARCHITECTURE



90 Broad Street, Suite 1803
New York, New York 10004
T: 212.465.0808

4724 Old Jacksonboro Hwy.
Wichita Falls, TX 76302
T: 940.397.0273

CH-2C



A

B

C

D

E

MANUFACTURER

Sit On It

REPRESENTATIVE

Carol Weiss
917.280.5193
Cweiss@exemplis.com

ITEM NAME

Rio

PRODUCT NUMBER

DIMENSIONS

W21.2 x D21.6 x H33.4 x SH17.9

WARRANTY

Lifetime

Photo for Reference Only

SUSTAINABILITY

Qualifies for LEED credits, see manufacturer's specs for details; UL Greenguard Gold

LOCATION

Refer to furniture plans

ADDITIONAL COMMENTS

No Arms; Carpet Casters

QUANTITY

10

Dealer to verify quantity via furniture plans

A	FINISH TYPE	Poly	B	FINISH TYPE	
	GRADE			GRADE	
	MANUFACTURER	SitOnIt		MANUFACTURER	
	NAME & NUMBER			NAME & NUMBER	
	COLOR	Tangerine		COLOR	
	COMMENTS			COMMENTS	

C	FINISH TYPE		D	FINISH TYPE	
	GRADE			GRADE	
	MANUFACTURER			MANUFACTURER	
	NAME & NUMBER			NAME & NUMBER	
	COLOR			COLOR	
	COMMENTS			COMMENTS	

FURNITURE SPECIFICATIONS

MIDWESTERN STATE UNIVERSITY

Moffett Library Renovation - Phase 2A

Contact: Alyson Kritz
akritz@holzmanmossbottino.com
212.465.0808

HOLZMAN MOSS BOTTINO
ARCHITECTURE



90 Broad Street, Suite 1803
New York, New York 10004
T: 212.465.0808

4724 Old Jacksonboro Hwy.
Wichita Falls, TX 76302
T: 940.397.0273

CH-3



A

B

C

D

E

MANUFACTURER

Turnstone

REPRESENTATIVE

Barbara Nevis
917.523.8979
barbara.nevis@coalesse.com

ITEM NAME

Jenny Lounge Chair, Round

PRODUCT NUMBER

DIMENSIONS

W30 x D32 x H31.75

WARRANTY

Lifetime

Photo for Reference Only

SUSTAINABILITY

SCS Indoor Advantage Certified; Contains Recycled Content; VOC-Free Manufacturing

LOCATION

Refer to furniture plans

ADDITIONAL COMMENTS

QUANTITY

16

Dealer to verify quantity via furniture plans

A	FINISH TYPE	Upholstery	B	FINISH TYPE	
	GRADE	7		GRADE	
	MANUFACTURER	DesignTex		MANUFACTURER	
	NAME & NUMBER	Phenomena 3879		NAME & NUMBER	
	COLOR	Sunset 701		COLOR	
	COMMENTS	100,000 DR; Nano Stain Resistant Finish; Bleach Cleanable		COMMENTS	

C	FINISH TYPE		D	FINISH TYPE	
	GRADE			GRADE	
	MANUFACTURER			MANUFACTURER	
	NAME & NUMBER			NAME & NUMBER	
	COLOR			COLOR	
	COMMENTS			COMMENTS	

FURNITURE SPECIFICATIONS

MIDWESTERN STATE UNIVERSITY

Moffett Library Renovation - Phase 2A

Contact: Alyson Kritz
akritz@holzmanmossbottino.com
212.465.0808

HOLZMAN MOSS BOTTINO
ARCHITECTURE



90 Broad Street, Suite 1803
New York, New York 10004
T: 212.465.0808

4724 Old Jacksonboro Hwy.
Wichita Falls, TX 76302
T: 940.397.0273

T-1

<div style="display: flex; justify-content: space-around;"> <div style="width: 100px; height: 100px; background-color: #f5f5dc;"></div> <div style="width: 100px; height: 100px; background-color: #a6a6a6;"></div> </div>											
A		B		C		D		E			
MANUFACTURER				Allsteel							
REPRESENTATIVE				Jessica Bogdan 347.346.0717 BogdanJ@allsteeloffice.com							
ITEM NAME				Aware - Flat Edge							
PRODUCT NUMBER											
DIMENSIONS				W72 x D30 x H29							
WARRANTY				Lifetime							
SUSTAINABILITY											
ADDITIONAL COMMENTS				Rectangular Table; T-Legs; Glides; Modesty Panel; Powered: 2R+2D, Provide Interlink IQ w/ pop-up receptical; Provide wire trough				LOCATION		Photo for Reference Only	
								QUANTITY		16 <i>Dealer to verify quantity via furniture plans</i>	
A	FINISH TYPE		Core Laminate		B	FINISH TYPE		Painted Metal Core			
	GRADE		L1			GRADE					
	MANUFACTURER					MANUFACTURER					
	NAME & NUMBER		Designer White			NAME & NUMBER		Fossil P28			
	COLOR					COLOR					
	COMMENTS					COMMENTS					
C	FINISH TYPE		Caster Colors		D	FINISH TYPE					
	GRADE					GRADE					
	MANUFACTURER					MANUFACTURER					
	NAME & NUMBER		Silver			NAME & NUMBER					
	COLOR					COLOR					
	COMMENTS					COMMENTS					
E	FINISH TYPE				F	FINISH TYPE					
	GRADE					GRADE					
	MANUFACTURER					MANUFACTURER					
	NAME & NUMBER					NAME & NUMBER					
	COLOR					COLOR					
	COMMENTS					COMMENTS					

FURNITURE SPECIFICATIONS

MIDWESTERN STATE UNIVERSITY

Moffett Library Renovation - Phase 2A

Contact: Alyson Kritz
akritz@holzmanmossbottino.com
212.465.0808

HOLZMAN MOSS BOTTINO
ARCHITECTURE



90 Broad Street, Suite 1803
New York, New York 10004
T: 212.465.0808

4724 Old Jacksonboro Hwy.
Wichita Falls, TX 76302
T: 940.397.0273

T-2

A		B		C		D		E			
MANUFACTURER				Allsteel							
REPRESENTATIVE				Jessica Bogdan 347.346.0717 BogdanJ@allsteeloffice.com							
ITEM NAME				Merge							
PRODUCT NUMBER											
DIMENSIONS				Dia48 x H29							
WARRANTY				Lifetime							
SUSTAINABILITY											
ADDITIONAL COMMENTS											
				LOCATION		Photo for Reference Only					
				QUANTITY		1					
						Dealer to verify quantity via furniture plans					
A	FINISH TYPE	Core Laminate				B	FINISH TYPE	Painted Metal Core			
	GRADE	L1					GRADE				
	MANUFACTURER						MANUFACTURER				
	NAME & NUMBER	Designer White					NAME & NUMBER	Fossil P28			
	COLOR						COLOR				
	COMMENTS						COMMENTS				
C	FINISH TYPE					D	FINISH TYPE				
	GRADE						GRADE				
	MANUFACTURER						MANUFACTURER				
	NAME & NUMBER						NAME & NUMBER				
	COLOR						COLOR				
	COMMENTS						COMMENTS				
E	FINISH TYPE					F	FINISH TYPE				
	GRADE						GRADE				
	MANUFACTURER						MANUFACTURER				
	NAME & NUMBER						NAME & NUMBER				
	COLOR						COLOR				
	COMMENTS						COMMENTS				

FURNITURE SPECIFICATIONS

MIDWESTERN STATE UNIVERSITY

Moffett Library Renovation - Phase 2A

Contact: Alyson Kritz
akritz@holzmanmossbottino.com
212.465.0808

HOLZMAN MOSS BOTTINO
ARCHITECTURE



90 Broad Street, Suite 1803
New York, New York 10004
T: 212.465.0808

4724 Old Jacksonboro Hwy.
Wichita Falls, TX 76302
T: 940.397.0273

T-3

A		B		C		D		E			
MANUFACTURER				Allsteel							
REPRESENTATIVE				Jessica Bogdan 347.346.0717 BogdanJ@allsteeloffice.com							
ITEM NAME											
PRODUCT NUMBER				Merge							
DIMENSIONS				Dia36 x H29							
WARRANTY				Lifetime							
SUSTAINABILITY											
ADDITIONAL COMMENTS											
		LOCATION		Photo for Reference Only		QUANTITY		22			
								Dealer to verify quantity via furniture plans			
A	FINISH TYPE	Core Laminate				B	FINISH TYPE	Painted Metal Core			
	GRADE	L1					GRADE				
	MANUFACTURER						MANUFACTURER				
	NAME & NUMBER	Designer White					NAME & NUMBER	Fossil P28			
	COLOR						COLOR				
	COMMENTS						COMMENTS				
C	FINISH TYPE					D	FINISH TYPE				
	GRADE						GRADE				
	MANUFACTURER						MANUFACTURER				
	NAME & NUMBER						NAME & NUMBER				
	COLOR						COLOR				
	COMMENTS						COMMENTS				
E	FINISH TYPE					F	FINISH TYPE				
	GRADE						GRADE				
	MANUFACTURER						MANUFACTURER				
	NAME & NUMBER						NAME & NUMBER				
	COLOR						COLOR				
	COMMENTS						COMMENTS				

FURNITURE SPECIFICATIONS

MIDWESTERN STATE UNIVERSITY

Moffett Library Renovation - Phase 2A

Contact: Alyson Kritz
akritz@holzmanmossbottino.com
212.465.0808

HOLZMAN MOSS BOTTINO
ARCHITECTURE



90 Broad Street, Suite 1803
New York, New York 10004
T: 212.465.0808

4724 Old Jacksonboro Hwy.
Wichita Falls, TX 76302
T: 940.397.0273

T-4



							
A	B	C	D	E			
MANUFACTURER		Turnstone				Photo for Reference Only	
REPRESENTATIVE		Barbara Nevis 917.523.8979 barbara.nevis@coalesse.com					
ITEM NAME		Campfire Personal Table					
PRODUCT NUMBER							
DIMENSIONS		W14 x D19.5 x H26					
WARRANTY		Lifetime					
SUSTAINABILITY						LOCATION	Refer to furniture plans
ADDITIONAL COMMENTS						QUANTITY	8 Dealer to verify quantity via furniture plans

A	FINISH TYPE	Standard Veneer	B	FINISH TYPE	
	GRADE			GRADE	
	MANUFACTURER	Turnstone		MANUFACTURER	
	NAME & NUMBER	3611 Natural Oak Veneer		NAME & NUMBER	
	COLOR			COLOR	
	COMMENTS			COMMENTS	

C	FINISH TYPE		D	FINISH TYPE	
	GRADE			GRADE	
	MANUFACTURER			MANUFACTURER	
	NAME & NUMBER			NAME & NUMBER	
	COLOR			COLOR	
	COMMENTS			COMMENTS	

E	FINISH TYPE		F	FINISH TYPE	
	GRADE			GRADE	
	MANUFACTURER			MANUFACTURER	
	NAME & NUMBER			NAME & NUMBER	
	COLOR			COLOR	
	COMMENTS			COMMENTS	